

FILENAME: N:\PROJECTS\A081750-1 - ASHTON GREEN\ACAD\DWGS\A081750-1-35-18-02\T0031\_LEICESTER ROAD & BEAUMONT LEYS LANE SIMPLIFIED CONCEPT FOR CONSULTATION\_REVA.DWG | PLOTTED BY: EDWARD DUCKER | PLOTTED DATE: 12 November 2015 11:30:54

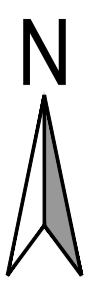

RED LINE DENOTES SUGGESTED KERBLINE REVISION TO NARROW THE CARRIAGEWAY. SPACE TO THE WEST OF THIS LINE TO EXISTING KERBLINE COULD BE USED FOR PLANTING OR OTHER FEATURES TO SHOW DRIVERS ARE WITHIN VILLAGE CENTRE

EXISTING FOOTWAY TO BE DESIGNATED AS SHARED FOOTWAY/ CYCLEWAY. WIDEN TO 3.0M WIDTH WHERE CONSTRAINTS ALLOW

SEE BEFORE AND AFTER IMAGES LOCATION 5A

LARGE NUMBER OF UTILITIES EQUIPMENT. IT MAY NOT THEREFORE BE FEASIBLE TO WIDEN THE FOOTWAY TO 3M IN THIS AREA AND THE SHARED FOOTWAY/ CYCLEWAY MAY BE RESTRICTED TO THE EXISTING FOOTWAY OVER A LOCALISED SECTION

EXISTING FOOTWAY TO BE DESIGNATED AS SHARED FOOTWAY/ CYCLEWAY. WIDEN TO 3.0M WIDTH WHERE CONSTRAINTS ALLOW

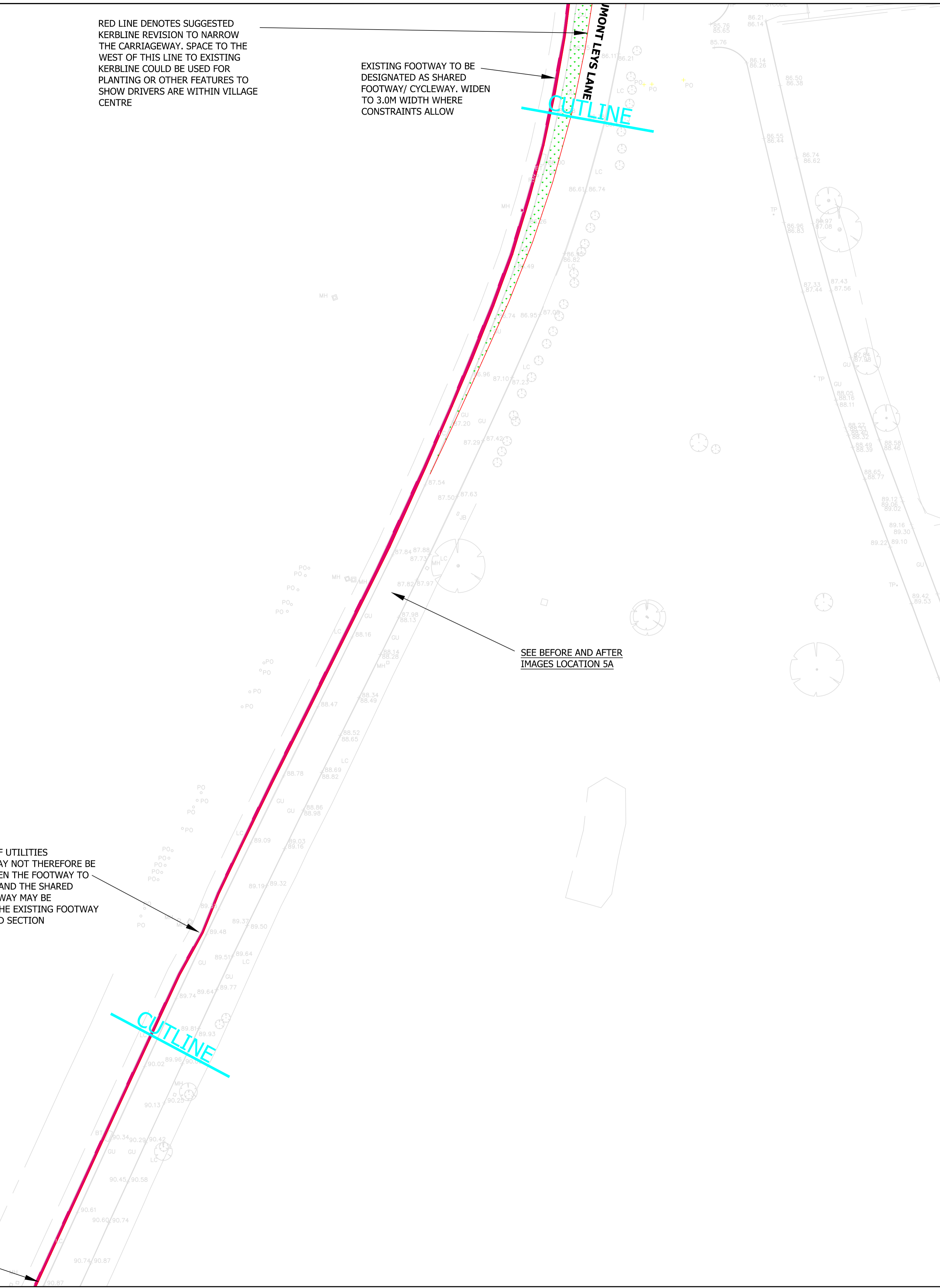

DO NOT SCALE. CONTRACTOR TO CHECK ALL DIMENSIONS AND REPORT ANY OMISSIONS OR ERRORS

**KEY**

- PROPOSED KERBLINE/ FOOTWAY EDGING
- WIDENING OF EXISTING FOOTWAY TO CREATE 3.0M WIDE FOOTWAY/ CYCLEWAY (2.0M MINIMUM WIDTH AT PINCH POINTS)
- PROPOSED GRASS VERGE

**NOTES**

1. BACKGROUND MAPPING CONTAINED IN LEICESTER CITY COUNCIL TOPOGRAPHICAL SURVEY "LEIC\_201" REV A (OCTOBER 2015).

REV	DESCRIPTION	BY	CHK	APP	DATE
A	LCC 09/11/15 EMAIL COMMENTS	ED	ED	ASG	12/11/15

Client:  
**LEICESTER CITY COUNCIL**

EXECUTIVE PARK  
AVALON WAY  
ANSTEY  
LEICESTER  
LE7 7GR  
TEL: +44 (0)116 234 8000  
FAX: +44 (0)116 234 8001  
e-mail: leicester@wyg.com



Project:  
**ASHTON GREEN**

Drawing Title:  
**LEICESTER ROAD/ BEAUMONT LEYS  
LANE IMPROVEMENTS  
CONSULTATION LAYOUT SHEET 5**

Scale @	A1	Drawn	Date	Checked	Date	Approved	Date
1:500		ED	29/10/15	CS	29/10/15	CS	29/10/15
Project No.	Office	Type	Drawing No.	Revision			
A081750-1	35	18	029	A			