

Proposed 20mph Speed Limit

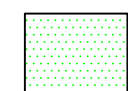

Existing 20mph Speed Limit

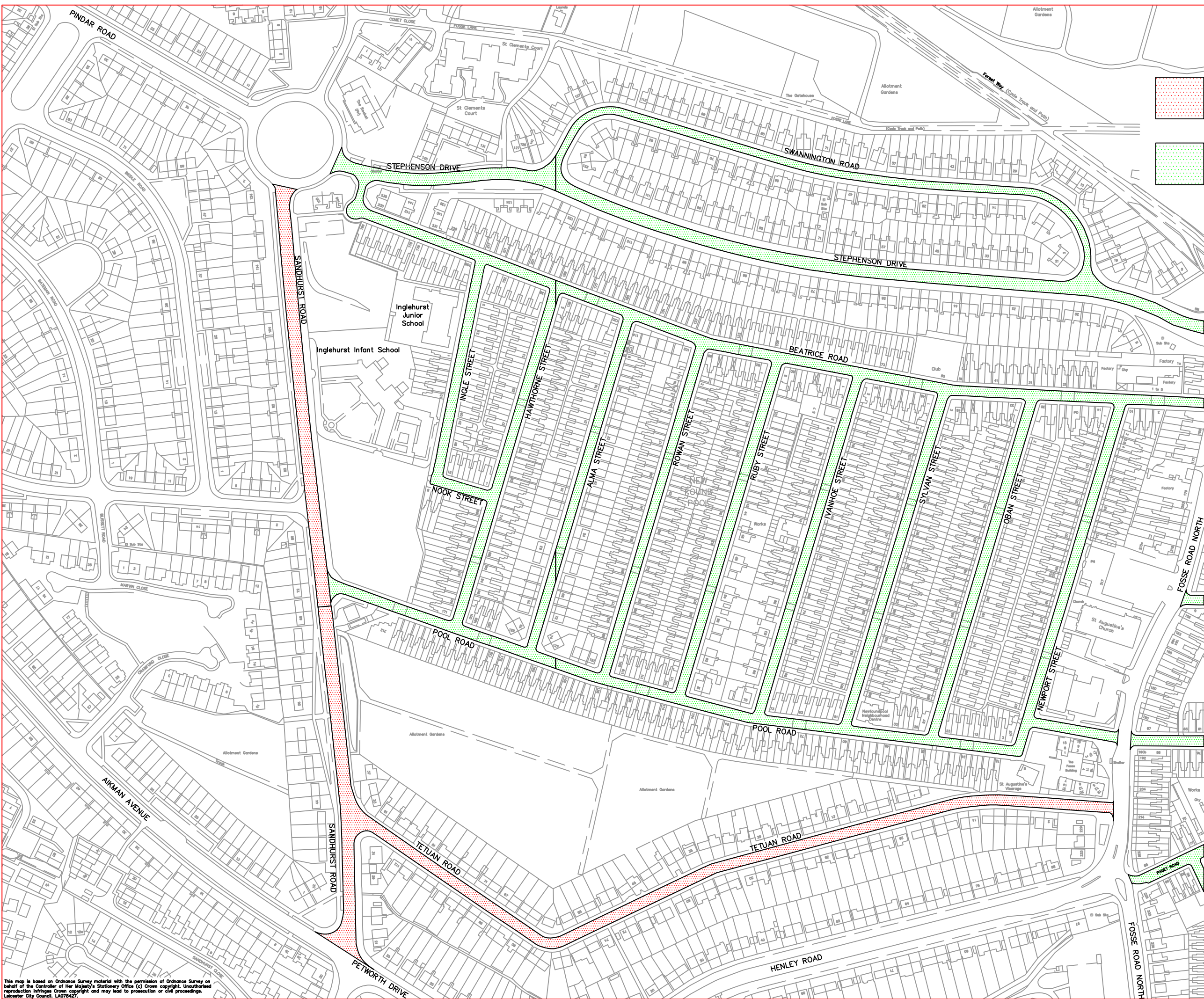

LEICESTER CITY COUNCIL

ANDREW L SMITH
Director, Planning, Transportation
and Economic Development

Fosse, New Parks and Western Park Wards
Sandhurst Road and Tetuan Road
Proposed 20mph Speed Limit

Drawing No.		Scale	
HD/N105842C/L(0)/20mph/CO1		1:2500	
Acad	SRW	Date	9th April 2013
Checked	BP	Size	A3
Acad File	Sandhurst	Letter File	N105842C

This map is based on Ordnance Survey material with the permission of Ordnance Survey on behalf of the Controller of Her Majesty's Stationery Office (C) Crown copyright. Unauthorised reproduction infringes Crown copyright and may lead to prosecution or civil proceedings. Leicester City Council, LA078427.