

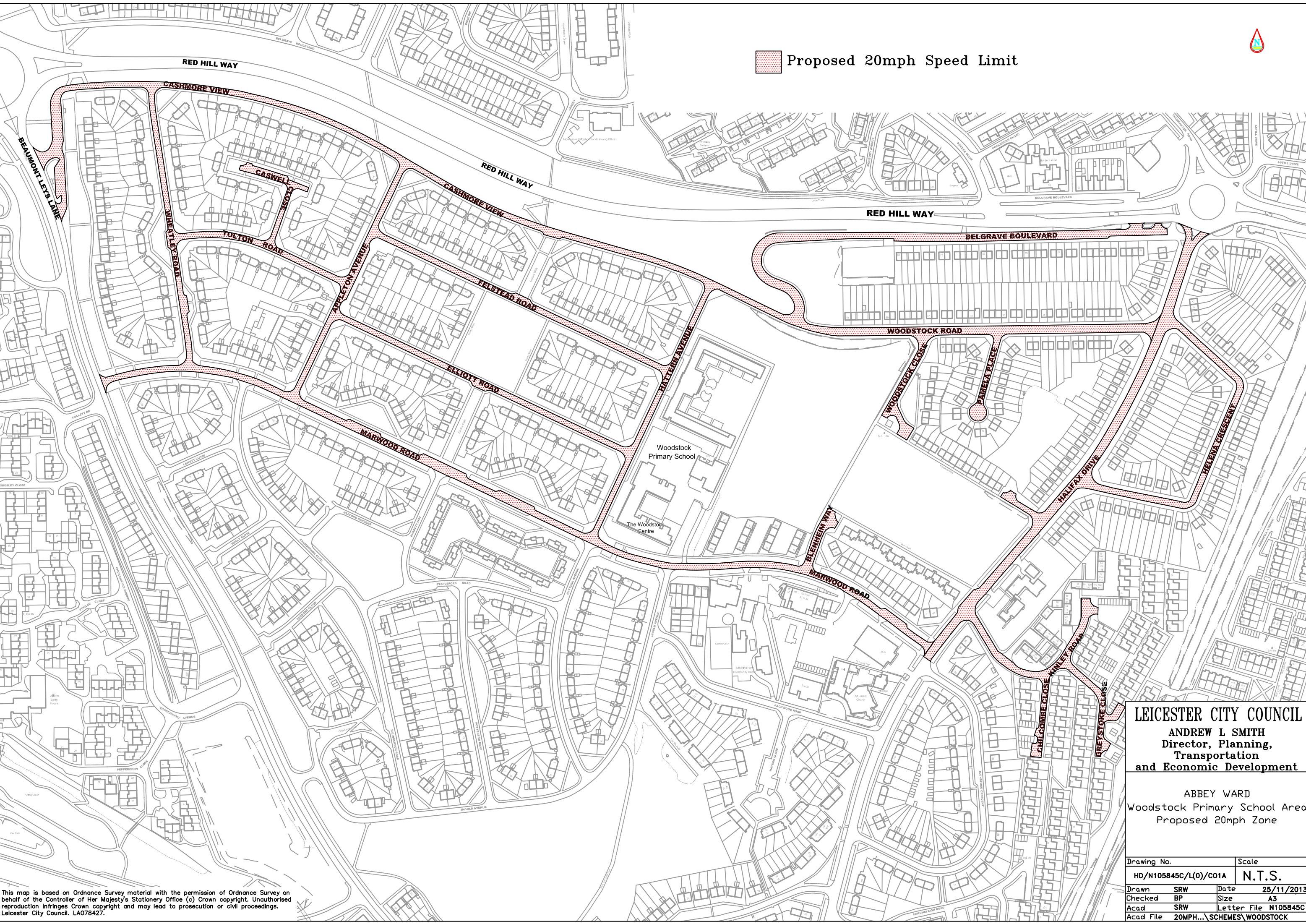

Proposed 20mph Speed Limit



**LEICESTER CITY COUNCIL**  
ANDREW L SMITH  
Director, Planning,  
Transportation  
and Economic Development

ABBEY WARD  
Woodstock Primary School Area  
Proposed 20mph Zone

Drawing No.	Scale
HD/N105845C/L(0)/C01A	N.T.S.
Drawn SRW	Date 25/11/2013
Checked BP	Size A3
Acad SRW	Letter File N105845C
Acad File	20MPH...SCHEMES\WOODSTOCK

This map is based on Ordnance Survey material with the permission of Ordnance Survey on behalf of the Controller of Her Majesty's Stationery Office (c) Crown copyright. Unauthorised reproduction infringes Crown copyright and may lead to prosecution or civil proceedings. Leicester City Council. LA078427.